

GDM S/C Series, Self-Contained, Swing Door Reach-In Coolers

model GDM-2 S/C shown below



- **Fully Self-Contained, Operates on 115V**
- **Full Vision Glass Doors Provides Optimum Display**
- **Perfect for Dairy and Beverage Merchandising**
- **Energy Efficient, Reversible, Self-Closing, Swing Doors**
- **Heated Door Frames**
- **Mirror Finish Stainless Steel Front**
- **Full Length Lighting for Maximum Visibility**
- **Rigid Insulation Seals in Cold Temperature**
- **Condensate Evaporator Eliminates Need for Drain**
- **Reliable and Proven Air-Cooled Refrigeration**



Marc Refrigeration

7453 Northwest 32nd Avenue, Miami, Florida 33147 • (305) 691-0500



GDM S/C Series, Self-Contained, Swing Door, Reach-In Coolers

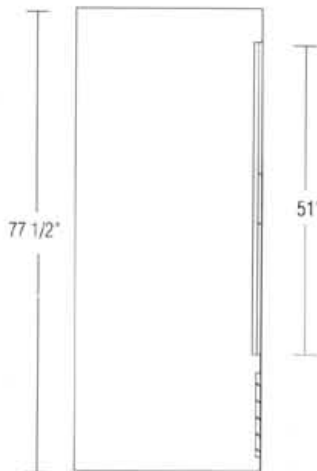

**While everyone else says there optional...
only Marc offers these kind of features *STANDARD!***

- **Quality Construction for a Longer Life**

Mirror finish, stainless steel front provides for a beautiful, easy to clean exterior surface. The bright white aluminum interior allows maximum light reflection and higher visibility. A stainless steel bottom pan, along with a heavy gauge steel frame, insures years of dependable, rust resistant service.

- **Self-Closing Swing Doors Offer Energy Efficiency**

Designed to visually merchandise your investment, the reversible, swing glass doors permit energy efficiency along with full vision display. Multi-pane thermoglass is used to protect against loss of temperature and moisture penetration. The self-closing mechanism makes certain that the doors are thoroughly closed after each opening. Also features a heated frame.

- **Full Length Lighting Provides Maximum Visibility**

Advanced product merchandising techniques are utilized in the lighting array. Each product facing features high illumination, full length fluorescents for maximum visibility of product.

- **Rigid Insulation Seals in Cold Temperature**

Rigid fiberglass insulation supplies excellent protection against ambient temperature incursion. It is further sealed to insure that there is no moisture infiltration.

- **Condensate Evaporator Eliminates Need for Drain**

The automatic, electric operated, condensate evaporator provides worry-free control of condensation. It completely eliminates the need for plumbing and drain connection.

- **Air-Cooled Refrigeration Offers Proven Reliability**

The heavy duty, air-cooled condensing unit is hermetically sealed and fully self contained. Each unit is proven reliable in all climates and is factory tested prior to shipping.

We reserve the right to change specifications without notice.



model	height	length	depth	shelf size	no. of doors	approx cubic ft	condenser unit HP	electrical volts & amps	approx shpg wt
GDM 1-S/C	80"	30"	31 1/4"	4 - 20 x 25	1	26	1/3*	115/1/60 - 12 amps	400 lbs
GDM 2-S/C	80"	54"	31 1/4"	8 - 20 x 23 3/8	2	44	1/2*	115/1/60 - 14 amps	550 lbs
GDM 3-S/C	80"	78"	31 1/4"	12 - 20 x 23 3/8	3	64	1/2*	+ 115/1/60 - 16 amps	700 lbs
GDM 4-S/C	80"	101 3/4"	31 1/4"	16 - 20 x 23 3/8	4	87	3/4*	+ 115/1/60 - 22 amps	850 lbs

* This size condenser unit is installed on this model.

** This size condenser unit is **RECOMMENDED** for this model. Consult a competent refrigeration mechanic to determine the appropriate size for your specific application. The appropriate condenser size will vary depending on length of run, indoor/outdoor use, etc.

+ Field electrical supply required.

**Marc Refrigeration Manufacturing, Inc., 7453 NW 32nd Ave., Miami, FL 33147 • (305) 691-0500
Fax (305) 691-1212**